



EBF Big Flange Circulation Pump



Operating Condition

1. Apply to heating system
2. Max. system pressure: 10bar
3. Operation condition: Ambient Temperature: 0°C~40°C Ambient Humidity: 95% Liquid Temperature: -10°C~110°C
Ambient temperature must be lower than liquid temperature, in order to avoid condensate water produced in the interior of stator.
4. Liquid : Clean, non-coorosive and non-explosive liquids, without any particle, fiber or mineral oil.
Water/glycol mixtures max. mixing ratio: 1:1
5. Dry running no more than 10min.

Model Definition

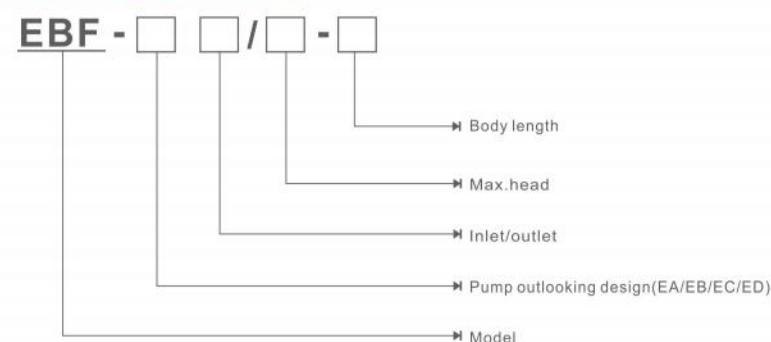

● Example: EBV-EA 25/6 is small circulation pump with cast-iron body, 25inlet/outlet, 6m head, 180mm body length

EBF 32 Series

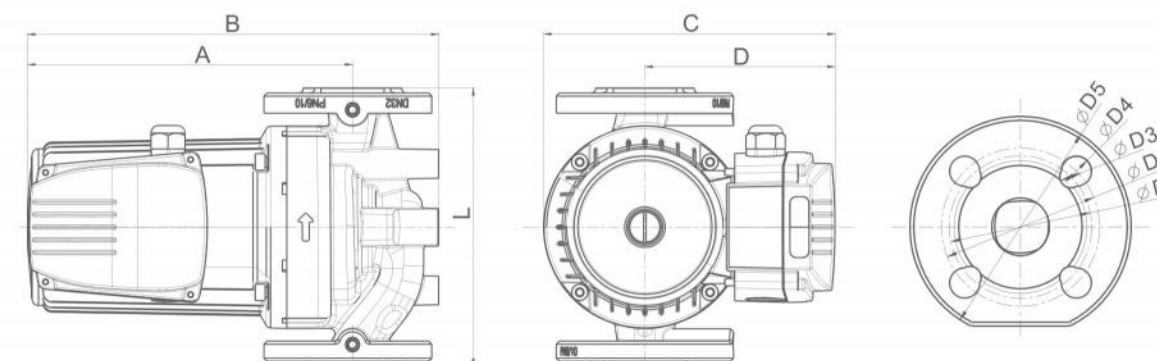

Performance Table

Model	Power	Max. flow	Max. head	Voltage		Pump dimension(mm)					Flangedimension(mm)					
	(W)	(m ³ /h)	(m)	220V/50Hz	380V/50Hz	L	A	B	C	D	D1	D2	D3	D4	D5	
EBF 32/6	250/210/200	9/8.3/7.1	6.3/6.1/5.8	●		220	233	292	228	80	90	100	14	19	140	DN32
EBF 32/6	235/170/150	9.7/8.5/8.1	6.3/5.8/5.6		●											
EBF 32/9	400/340/300	11.8/10.3/8	9.2/8.9/8.3	●												
EBF 32/9	370/280/260	12.4/10.6/9.85	9.2/8.35/8		●											

EBF 40 Series

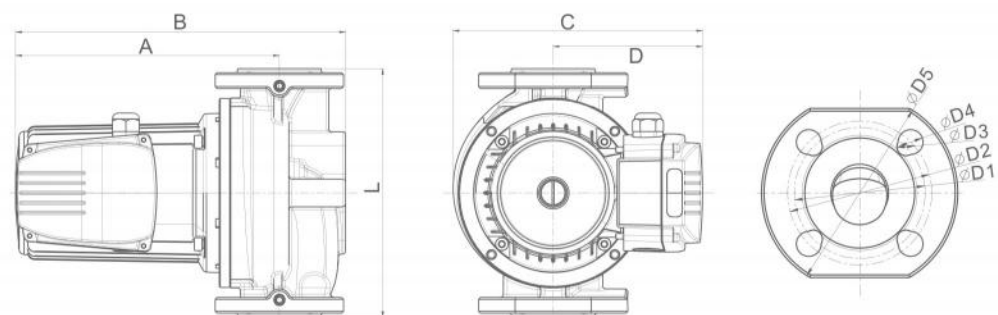

Performance Table

Model	Power	Max. flow	Max. head	Voltage		Pump dimension(mm)					Flangedimension(mm)					
	(W)	(m ³ /h)	(m)	220V/50Hz	380V/50Hz	L	A	B	C	D	D1	D2	D3	D4	D5	
EBF 40/6	260/230/220	10.8/9.9/8.4	6/5.7/5.4	●		250	230	298	228	100	100	110	14	19	150	DN40
EBF 40/6	260/190/175	10.8/9.5/9	6/5.4/5.2		●		230	298	228							
EBF 40/9	570/560/540	14/13.4/12.4	10/9.6/9.1	●			262	329	250							
EBF 40/9	560/430/390	13.7/12.1/11.3	10/8.8/8.3		●		232	299	250							
EBF 40/13	800/730/690	15.8/14.7/12.4	12.8/12.1/11	●			262	329	250							
EBF 40/13	750/540/480	15.3/12.7/11.6	12.5/10.4/9.5		●		232	299	250							
EBF 40/18	1100/890/770	16.2/14.2/11	17.2/15.9/13.7	●			262	329	250							
EBF 40/18	1090/710/590	16.5/12.8/11.3	17.5/13.1/11.2		●		262	329	250							

EBF 65 Series

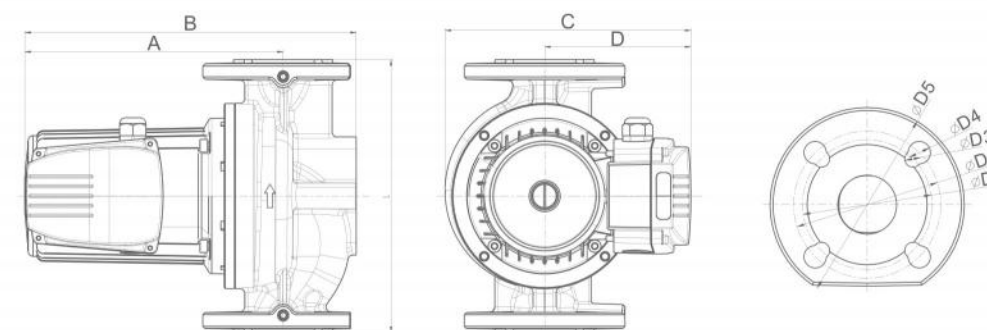

Performance Table

Model	Power	Max. flow	Max. head	Voltage		Pump dimension(mm)					Flangedimension(mm)					
	(W)	(m ³ /h)	(m)	220V/50Hz	380V/50Hz	L	A	B	C	D	D1	D2	D3	D4	D5	
EBF 65/6	590/470/450	25.8/25.3/23.8	6.2/6.1/6	●		340	256	341	246	96	130	145	14	19	185	DN65
EBF 65/6	490/370/340	25.3/22.2/20.9	5.9/5.1/4.7		●		226	311	246							
EBF 65/9	1060/850/740	36/30/27	10/9.5/8.9	●			256	341	246							
EBF 65/9	1010/670/570	36/27.4/24	10/8.4/7.7		●		256	341	246							
EBF 65/13	1420/1060/930	40.8/34.5/32.8	13.2/11.9/11.2		●		286	371	246							

EBF 50 Series

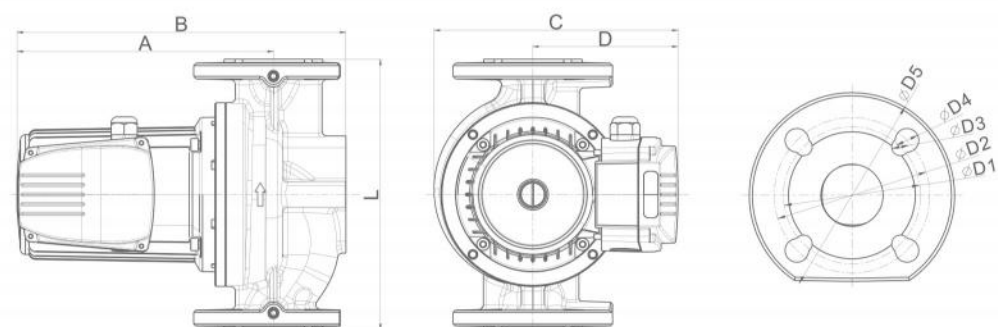

Performance Table

Model	Power	Max. flow	Max. head	Voltage		Pump dimension(mm)					Flangedimension(mm)				
	(W)	(m ³ /h)	(m)	220V/50Hz	380V/50Hz	L	A	B	C	D	D1	D2	D3	D4	D5
EBF 50/6	410/360/310	15.5/13.2/9.8	6.2/6/5.6	●		280	209	281	236	110	125	14	19	165	DN50
EBF 50/6	360/260/230	15.5/12.6/11.4	6.1/5.4/5.1		●		209	281	236						
EBF 50/9	760/670/640	20.4/18.9/16.5	9.4/9.2/8.9	●			239	331	236						
EBF 50/9	680/500/460	20.1/17/15.2	9.2/8.3/7.6		●		209	281	236						
EBF 50/13	1140/960/790	24.9/21.2/15.6	13/12.4/11.4	●			262	337	252						
EBF 50/13	1160/750/620	25.9/19.6/17.5	12.5/10.5/9.6		●		262	337	252						
EBF 50/18	1160/960/800	23.2/20/14.8	17.4/16.1/13.5	●			262	337	252						
EBF 50/18	1280/970/880	24.7/22.1/20.6	17.9/15.7/14.6		●		262	337	252						

EBF 80 Series

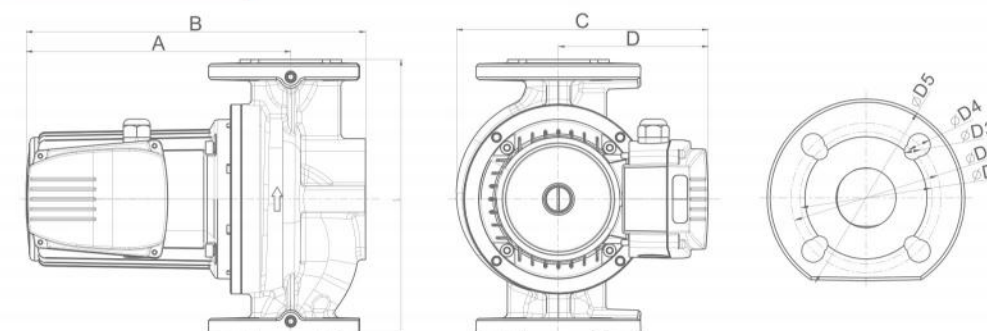

Performance Table

Model	Power	Max. flow	Max. head	Voltage		Pump dimension(mm)					Flangedimension(mm)				
	(W)	(m ³ /h)	(m)	220V/50Hz	380V/50Hz	L	A	B	C	D	D1	D2	D3	D4	D5
EBF 80-6/4	710/610/450	40.8/35.6/23.7	5.1/4.7/3.9	●		360	308	415	276	126	160		8*19	200	DN80
EBF 80-6/4	780/500/430	44/35.5/32	5.2/4.4/4.1		●										
EBF 80-9	1490/1070/940	52.8/44.1/40.5	9.2/7.8/7.2		●										



EBF-BG 32/11 EBF-B 32/11

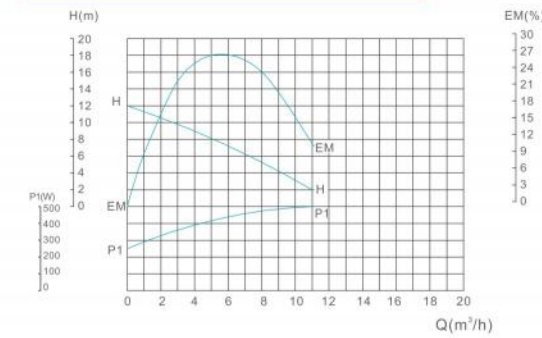

EBF-B 32/12 EBF-B 40/12 EBF-B 50/12

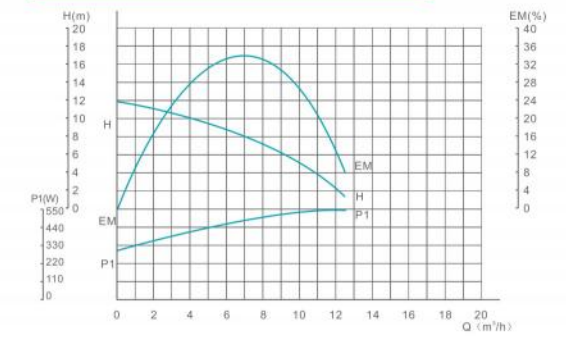

EBF-B 32/17 EBF-B 40/17 EBF-B 50/17

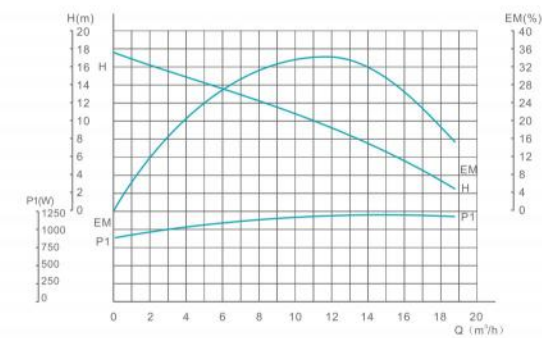

EBF-B 32/18 EBF-B 40/18 EBF-B 50/18

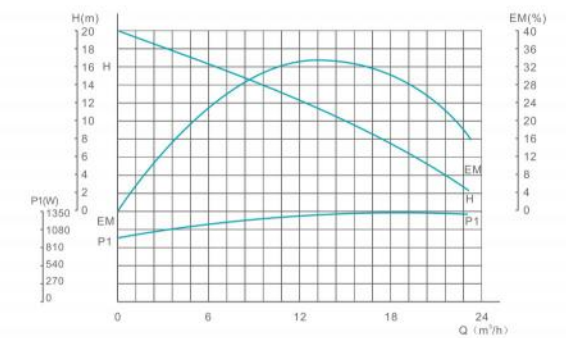

EBF-B 65/13

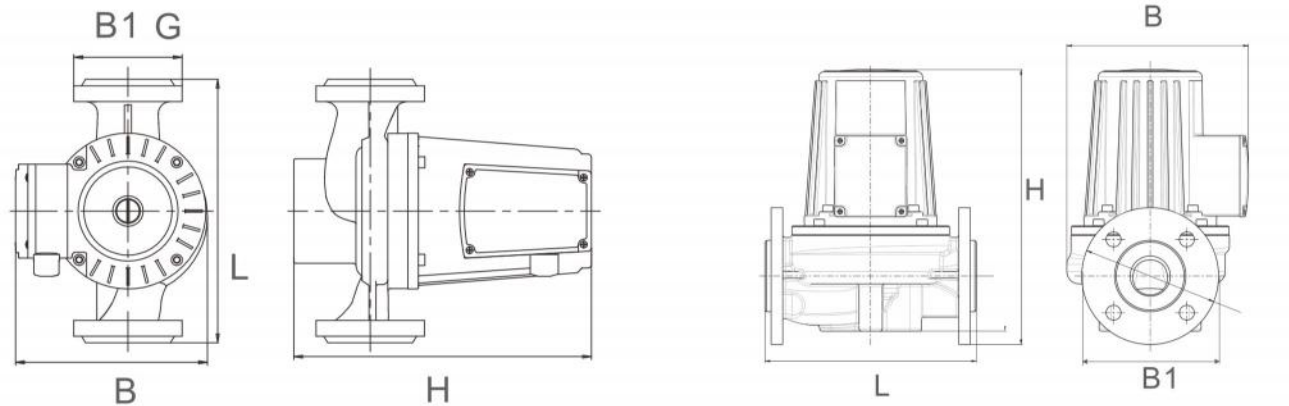
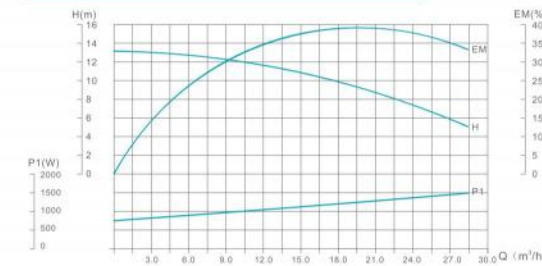

EBF-BG370 EBF550 EBF750 EBF1100 EBF1500

DN40 DN50 DN65

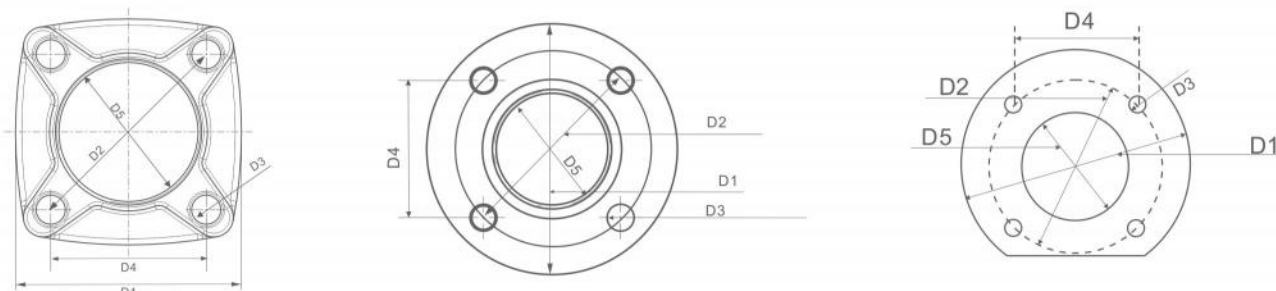

EBF-BG370

EBF550 EBF750
EBF1100 EBF1500

DN40 DN50 DN65

Performance Table

Model	Power (W)	Max. flow (m³/h)	Max. head (m)	Voltage			Pump dimension(mm)					Flangedimension(mm)					Weight (Kg)		
				220V/50Hz	220V/60Hz	380V/50Hz	L	B	B1	H	G	D1	D2	D3	D4	D5			
EBF-B 32/11	400	10.2	11				224	180	59.5	210	2"								9
EBF-BG 32/11	400	10.5	11				224	163	92	253	2"	93	90.5	12	64	57.2			11
EBF-B 32/12	550	10.5	12				225	160	126	253	2"	128	99	12	70	57.2			14.5
EBF-B 32/17	750	18.6	17				255	219	126	314	2"	128	99	12	70	57.2			24
EBF-B 32/18	1100	23.1	18				255	219	126	314	2"	128	99	12	70	57.2			25
EBF-B 40/12	550	12	12	●	●	●	225	162	150	255	2"	150	110	12	77.8	57.2			16
EBF-B 40/17	750	18.6	17				255	219	150	249	2"	150	110	12	77.8	57.2			25
EBF-B 40/18	1100	23.1	20				255	219	150	249	2"	150	110	12	77.8	57.2			25.5
EBF-B 50/12	550	12	12				225	162	165	255	2"	165	125	12	88.4	57.2			16.5
EBF-B 50/17	750	18.6	17				255	219	165	249	2"	165	125	12	88.4	57.2			26
EBF-B 50/18	1100	23.1	20				255	219	165	249	2"	165	125	12	88.4	57.2			27
EBF-B 65/13	1500	28	13				300	211	185	304	2.5"	165	145	18	102.5	72.5			28



Feature

Shielding pump, variable frequency adaptive, quiet and efficient

Advantage

- Permanent magnet motor
- Frequency conversion technology
- Memory function
- Constant voltage automatic function
- Use hot and cold water at the same time- -pressurization and circulation.
- Protection function: rotor locked protection, open circuit protection,overheat protection,short circuit protection

Application

Air conditioning, refrigeration secondary system
Combined heating and circulation

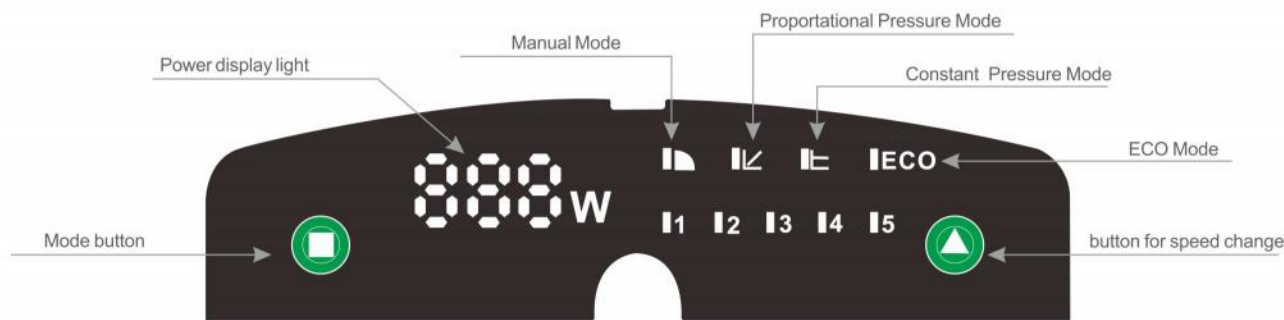

	Manual Mode		Light for each speeds
	Proportational Pressure Mode		Mode button
	Constant Pressure Mode		Button for speed change
	ECO Mode		Power display Light

EBF-EA 40/600

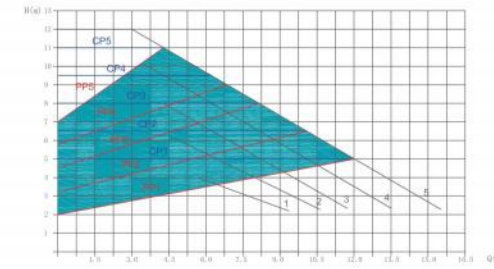

EBF-EA 65/600

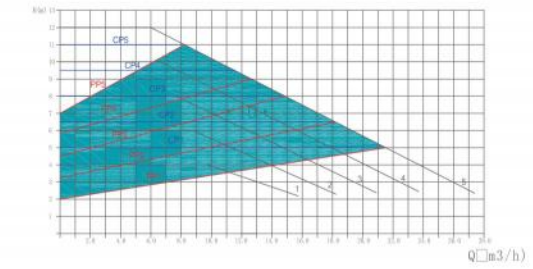

EBF-EA 50/600

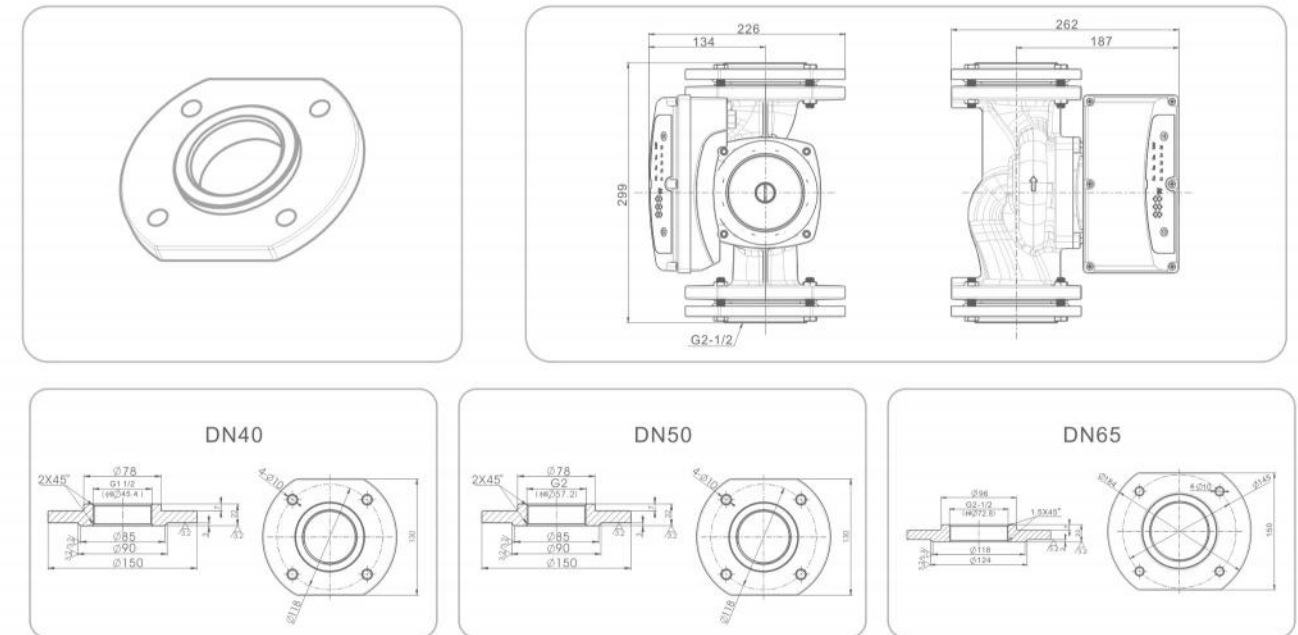
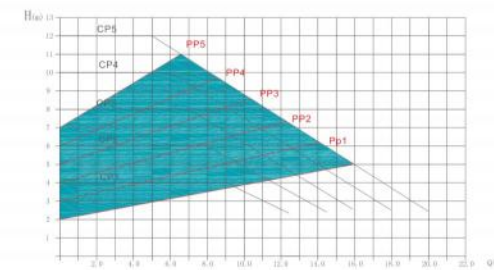

Performance Table

Model	Connection size (Inch)	Rated flow (m³/h)	Rated head (m)	Max. head (m)	Rated power (W)	Input power (W)
EBF-EA 40/600	2"	7	9.5	12	600	600
EBF-EA 50/600	2"	12	9.5	12	600	600
EBF-EA 65/600	2"	13	9.5	12	600	600